

## WOOD SWING DOOR (IN SWING)

When recessed, the **Inswing Weather Resistant Sill** provides effective weather sealing for exterior applications. It's important that the exterior surface level is lower than the sill to enable water drainage.

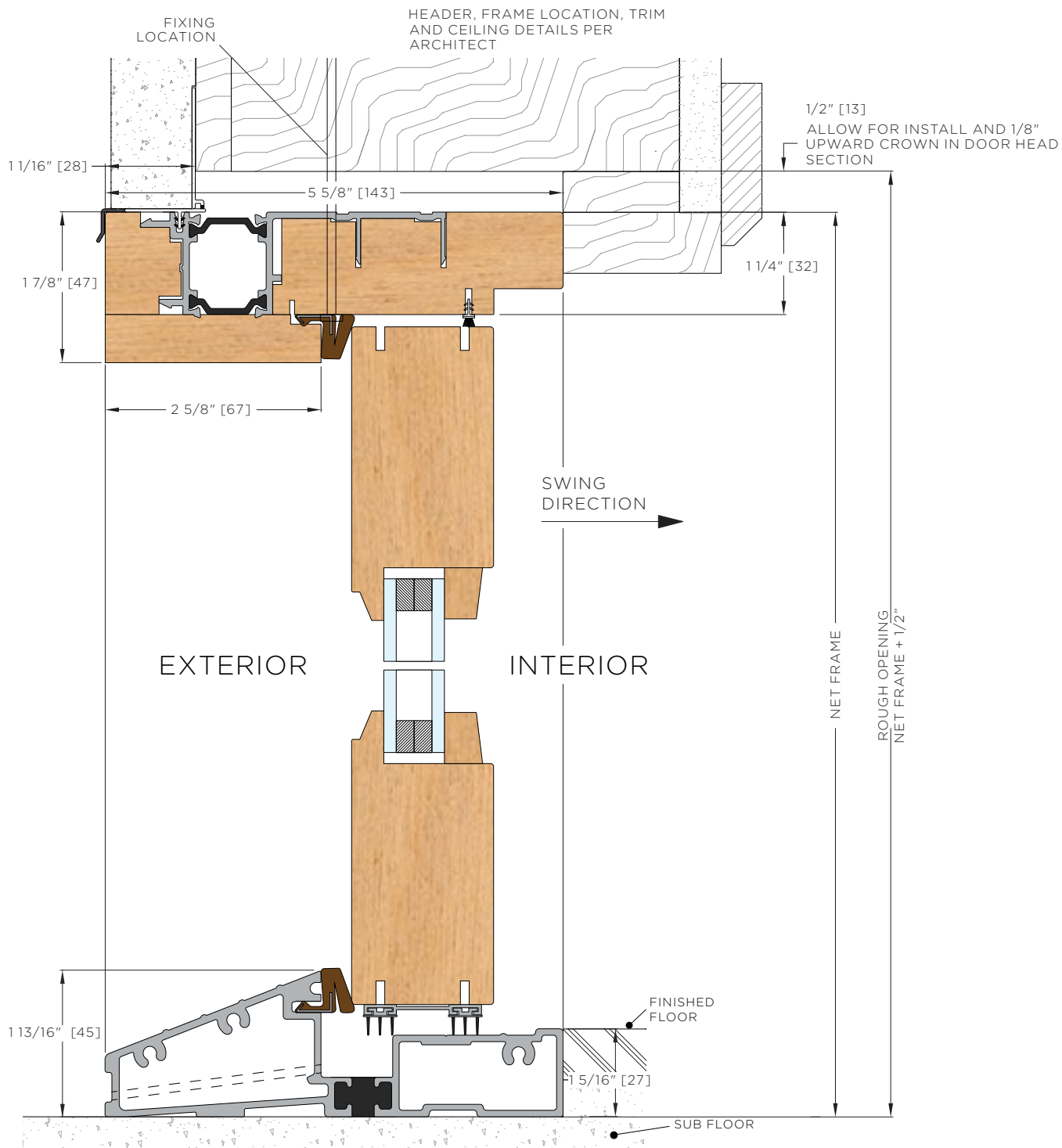

WOOD SWING DOOR (IN SWING)

**LaCantina Doors** inswing frame depth is 5 5/8" and is suitable for common 2 x 4 framing with stucco and drywall. The frame depth can be extended with jamb extensions on the interior for thicker wall conditions or desired trim detail. The location of the **LaCantina Doors** frame in the wall condition will depend on the trim detail desired.

SINGLE DOOR

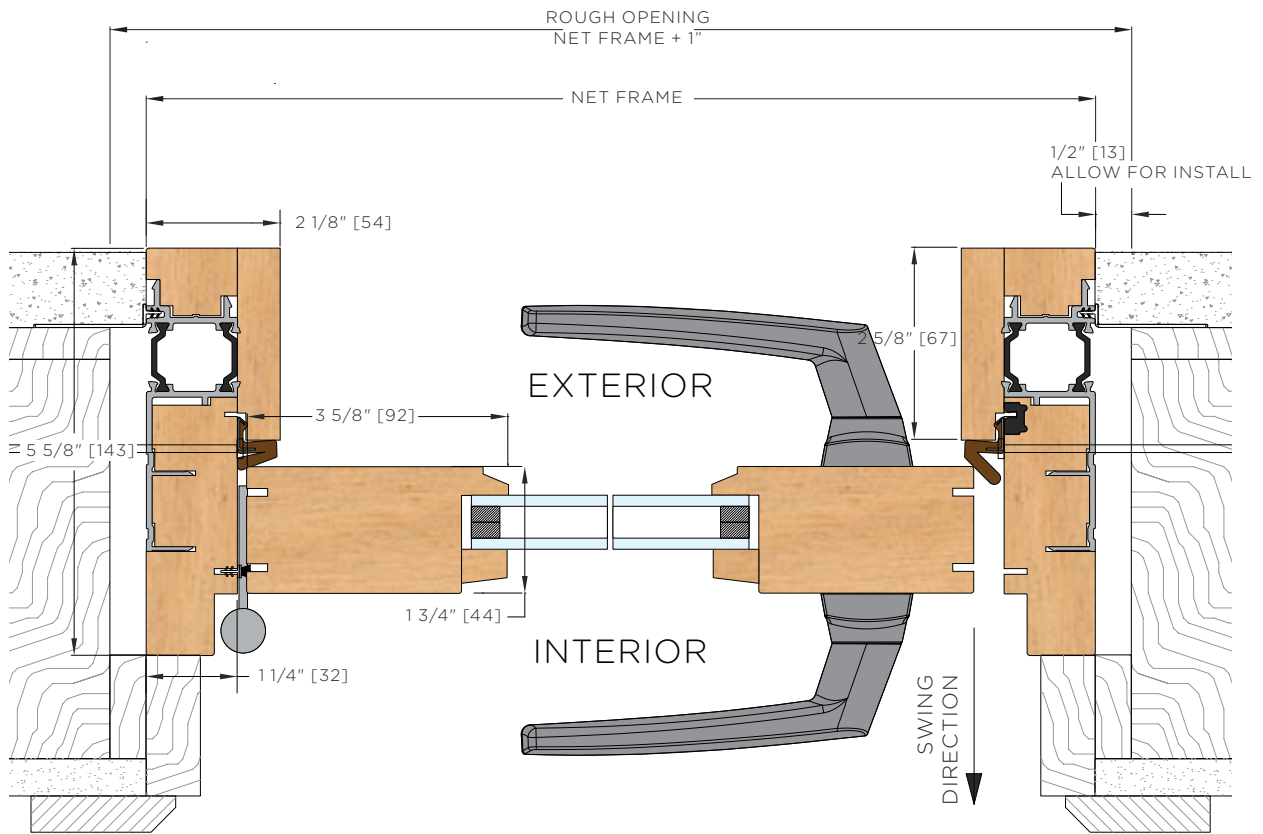

DOUBLE DOOR ASTRAGAL

