

ALUMINUM XO SLIDER

The **Weather Resistant Sill** is made from extruded aluminum with a thermal break and self-draining weep system to provide effective weather sealing for exterior applications. The **Weather Resistant Sill** can be installed into the sub floor allowing the interior finish floor to be level with the interior sill stop, resulting in a minimized transition from inside to outside.

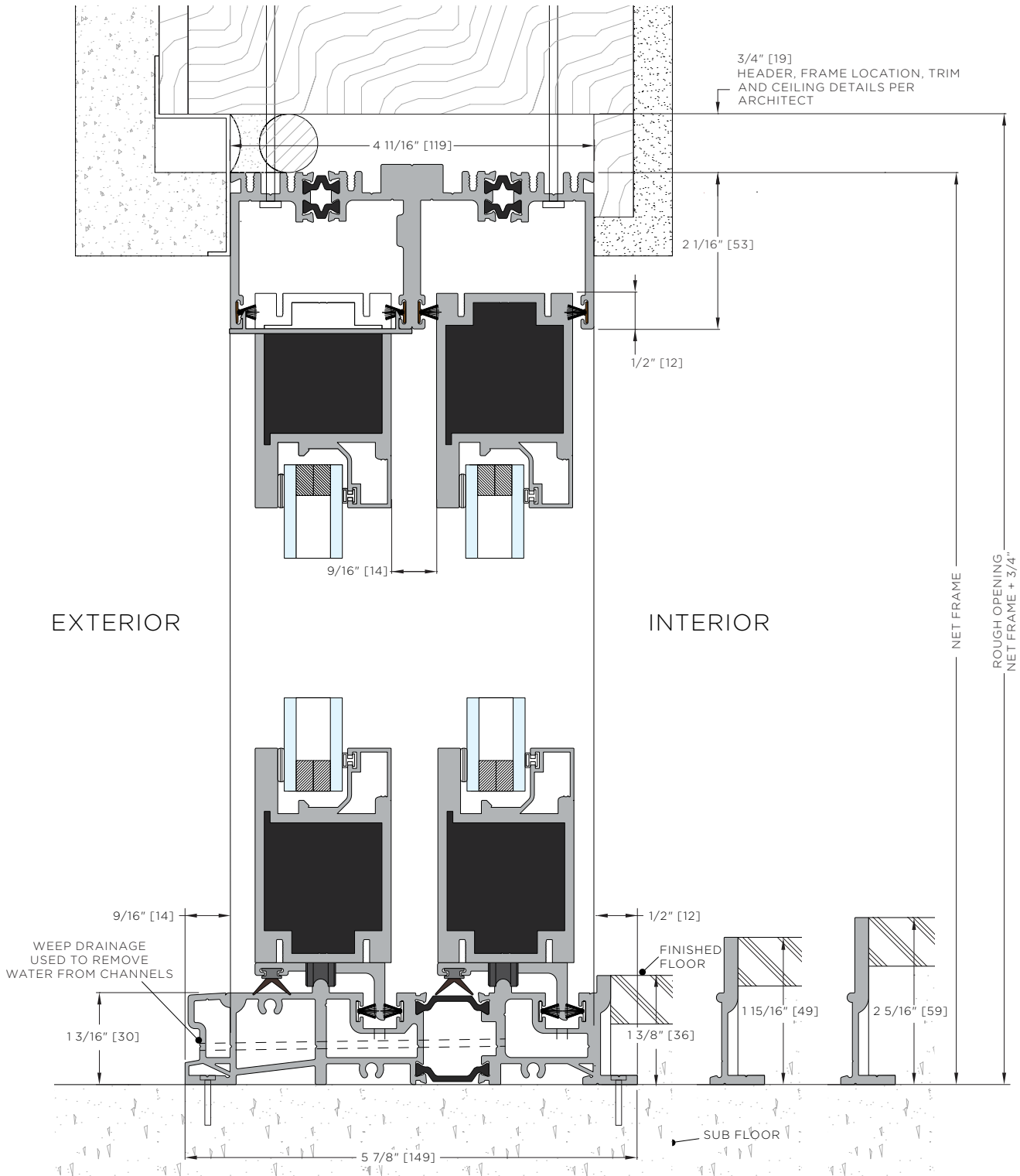

ALUMINUM XO SLIDER

LaCantina Doors Aluminum sliding door frame depth is 2 5/16" per panel as standard. The location of the **LaCantina Doors** frame in the wall condition will also depend on the trim detail desired.

